

# Graupner

## No. 7903

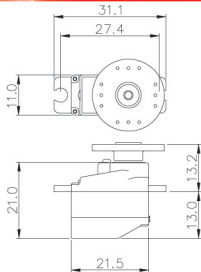

# SERVO



### Technische Daten

Stellmoment/4,8 V, ca.	17 Ncm
Stellmoment/6,0 V, ca.	20 Ncm
Stellzeit/4,8 V, ca.	0,125 Sek./40°
Stellzeit/6,0 V, ca.	0,1 Sek./40°
Gewicht, ca.	8 g

### Specification

Torque/4,8 V, approx.	17 Ncm
Torque/6,0 V, approx.	20 Ncm
Speed/4,8 V, approx.	0,125 Sec./40°
Speed/6,0 V, approx.	0,1 Sec./40°
Weight, approx.	8 g

# DES 261 BB

Made in Korea **PN.PE-01**

GRAUPNER GmbH & Co. KG · D-73230 KIRCHHEIM/TECK · [www.graupner.de](http://www.graupner.de)